



New 10m Prolyte Bandstand XL

Following a high demand for our existing 6.7m Litestructures Bandstands throughout 2011, we have added a newly commissioned Bandstand XL structure for 2012. Constructed by Prolyte, and with an overall diameter of 10m, the bandstand is based on a LiteDeck stage platform. The Bandstand has full structural calculations to be used at either 4m or 3m high leg heights. The 3m high configuration is shown above on the stage's first outing in Coventry City Centre for their Christmas celebrations. The structure has a Green and Blue roof canopy, and can be supplied with various different stage platform, step and handrail configurations.

Alongside the Prolyte Bandstand XL, we also have a new Prolyte Custom CLT stage, which was in operation at the end of last summer, and is already attracting bookings for 2012. The massive 16m x 14m stage has a clear trim height of 9m, with a roof loading of 10000kg, plus 4000kg on optional PA wings. The CLT Roof System is constructed from S52SV grid truss supported by seven S40T truss towers from the Prolyte Structures range. A Layher Allround Scaffolding system constructed from EV100 Event Decks that form the stage platform. Adjustable Layher base adaptors support the truss towers, and tie the structure into the platform.



16m x 14m Prolyte Custom CLT at Glamis Castle

We also have huge stocks of the LiteDeck modular staging system, with over 800 decks available and a comprehensive range of fittings and accessories. Staging packages are still available for summer 2012 including during the Olympics - please contact us for further details.

D&B Now in Stock



IPS has recently invested in a range of D&B audio equipment. Speaker cabinets available include the new T10 compact line array or point source system, reinforced with B4 Subwoofers. This is complimented by the E6, a small cabinet that replaces the now discontinued E3- very popular on corporate shows with compact dimensions and high speech intelligibility. All our D&B systems are driven by D12 and D6 Amplifiers, and we also have a range of hardware to hang or stand everything in a variety of formats.

Even More Control!



Now in stock is a Chamsys MaqicQ MQ100 Pro 2010 lighting desk. To compliment the existing Avolites product range, the Chamsys is ideal

for the larger shows, with 32 universes accessible directly via Art-Net from the built in Ethernet switch. On board LED pixel mapping, and a customisable user interface mean that this desk is suitable for busking with a band or stepping through a theatre cue stack- and most things in between.

Video Equipment

IPS stocks a range of video equipment, from leading industry manufacturers. Stock includes 7000 lumen Sanyo Projectors with a range of lens options and fastfold screen sizes. We have Panasonic Plasma Screens, with full HD resolution and 42" and 50" models available, with a full range of Unicol stands and flying hardware.

For delivering content, we have Dell Vostro laptops with dedicated graphics cards & PowerPoint 2010. We also have USB RF Wireless Cue Light systems.

To integrate with lighting equipment, we also have a lo-res video screen, the 37.5mm pitch Pixel Mesh system, and a Hippo Critter Media server to drive it all.

Supporting the video equipment is a range of VGA & BNC cabling, along with a range of TourCat 5 cable, and VGA over Cat5 systems, along with various other Kramer Distribution systems. Please contact us for more information on any of the above.



Martin MAC Aura

Neatly filling the gap between the larger MAC 401 and the compact and super fast MAC 101 is the new Martin MAC Aura. Launched at PLASA 2011, this high output LED fixture has RGBW LED's enabling smooth colour reproduction throughout the 11 to 58 degree beam range. The fixture also has two different LED sources, enabling the lens to be backlit in a contrasting - or identical colour to the main output. This combined with the built in FX engine mean a huge range of looks can be created, even in a high ambient light situation where beams of light may not be visible.

Flightcased in multiples of six with PowerCon in and through power connectors, and 5 pin XLR connectors for DMX. With compact dimensions and low power consumption these units are ready to be used in a range of scenarios.



Prolyte H40R Truss - In Black

The new Prolyte H40R truss is now in stock. It is also the first range of truss that we have available in Black. The H40R has the loading capacity of H40V, the compact dimensions similar to H30V, and also the horizontal chord design from S36R allowing for easy placement of moving head fixtures.

Intelligent spigot orientation allows the truss to be easily constructed on the floor, and with the ability to use H30V legs to support a box truss structure this truss can form part of a flexible rigging solution. IPS also have in stock the adaptable box corners to connect it all together.

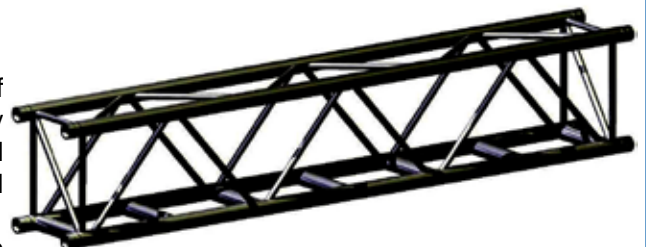

Truck It with IPS

IPS has an 18t Truck added to the fleet. Alongside our 3.5t Vans, 7.5t Trucks and Step Frame Artic. Competitive prices, and with a 26'x8' load area, and huge weight loading, we can now carry even more kit for your events!



GDS HO Wireless Uplighters

GDS High Output Wireless LED Uplighters are now in stock. Flightcased in multiples of six, these units offer up to 12 hours run time from their internal rechargeable battery. Operating either as stand alone units, or controlled via wireless DMX, these are a quickly deployable solution with an IP45 rating so they can be used outdoors. A smart stainless steel finish means they blend into almost any environment.



RAT Music Stands

Industry standard RAT Opera range of music stands complete with lights are now in stock. A frequently requested item, we have single stands and the double width conductors stand available.

Keep the orchestra happy, and make sure they can read their music! Contact us for further details.

